

Personal Shredder P8GC

Instruction Manual

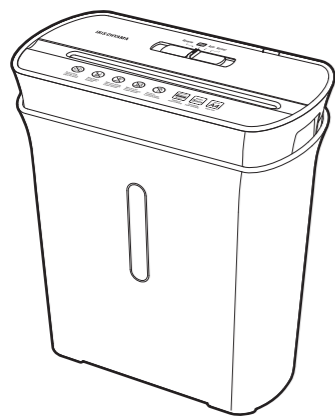

Contents

- Safety precautions.....2
- Usage precautions.....5
- Parts.....6
- Operation instructions.....7
- If the shredding process suddenly stops.....8
- If shredded waste have accumulated.....8
- Safety system.....9
- Maintenance.....9
- Troubleshooting.....10
- Specifications.....11
- Warranty and after-sales service.....11
- Warranty card.....Back cover

Brand Principal : IRIS Ohyama Inc.,
 Address : 2-12-1, Itsutsubashi, Aoba-ku, Sendai-shi, Miyagi-ken, Japan
 Distributor :
IRIS OHYAMA (THAILAND) CO., LTD.
 Address : No. 399 Interchange 21, Room No. 2208, 22 Floor, Sukhumvit Road,
 Klongtoey Nua Sub-district, Wattana District, Bangkok 10110

Safety precautions

Make sure to follow this "Safety Precautions" first in order to use the shredder correctly. The safety precautions describe the matters required to be observed in order to prevent any personal injury or property damage.

Examples of symbols

	This symbol means "Reminding".		This symbol means "Reminding".		This symbol means necessary "Instruction".
--	--------------------------------	--	--------------------------------	--	--

Warning

The symbol means risks which may lead to death or a serious injury during faulty operation.

- Turn off the power supply and unplug the product from the socket if there is any abnormality, such as smoke and/or a burning smell**
Failure could cause a fire or an electric shock. In this case, stop using the product and contact the store where the product was purchased from or the Iris Call Center.
- Do not spray liquids (insecticides, hair care products, or lubricating oil) on the product**
Failure could cause ignition resulting in a fire.
- Do not use the product near combustible substances (such as kerosene, gasoline, and thinner), ignited objects (such as a cigarette and an incense stick), and flammable substances**
Failure could cause a fire.
- Do not disassemble, repair, or modify the product**
Failure could cause a fire, an electric shock or an injury.
- Do not use the product in a humid place, such as a wet area or a bathroom**
- Do not wet the product or immerse it in water**
Failure could cause a fire or an electric shock.
- Do not install the product at an unstable place**
Failure could cause the product to fall over or drop, resulting in an injury or property damage.
- Do not step on the product or place an object on the product**
Failure could cause an injury or property damage.

- Remove dust from the plug periodically**
Accumulation of dust may cause poor insulation of the product due to humidity, etc., resulting in a fire or an electric shock.
- Plug the product into the socket thoroughly**
Failure could cause a short circuit, resulting in a fire or an electric shock.
- Be sure to unplug the product from the socket when conducting maintenance or inspection or relocating the product**
Failure could cause an electric shock or an injury.
- Do not insert or remove the plug with a wet hand**
Failure could cause an electric shock, a burn, or an injury.
- Do not use the product when cord or the socket is damaged, or the product is plugged into the socket loosely**
Failure could cause a short circuit, resulting in a fire or an electric shock.
- Do not use the product at any voltage except the rated voltage specified for the socket or the extension cord**
Failure could cause a fire.
- Do not power on when the power cords are bundled**
Failure could cause overheat resulting in a burn or a fire. Extend the cord fully when using it.
- Do not damage the power cord. Do not pull the power cord forcibly when moving or storing the product**
Do not damage or press the power cord, forcibly bend or stretch the power cord, twist, place heavy objects on or modify the power cord. Failure could cause damage to the power cord, resulting in a fire or an electric shock.
- Do not use an AC Power source other than 220V**
Failure could cause a fire or an electric shock.
- Do not let infants touch the product plug**
Failure could cause an injury or an electric shock.
- Do not let children use the product**
Failure could cause a serious injury.

Personal Shredder P8GC		Warranty card	
The purchase receipt constitutes the certificate so you can enjoy free repairs in accordance with the following repair provisions within the next period from the day of purchase.			
Purchase date*		Warranty period	
		1 years from the day of purchase <small>*Except for consumables</small>	
Customer	Name:		Shop name:
	Postal code: Address:		Address:
	Telephone number () -		Telephone number () -
		*Retail shop	
Notice to retail shops: Please fill in the fields marked with a * symbol and then deliver it to your customer.			

Warranty provisions

- 1 The company will provide free repairs or replacements in conditions of malfunction or damage present under normal operating conditions as per the aspects that must be given attention according to the labels affixed on the operation manual and the product.
- 2 Warranty repairs can only be performed by an authorised service centre. When filling a warranty claim, the original bill of purchase (with the date of purchase) must be submitted.
- 3 The warranty contents are only limited to the free repair of the product. No other warranty service is provided even within the warranty period. The warranty only covers defects in materials or workmanship.
- 4 The warranty will not apply in cases of:
 - ① Normal wear and tear
 - ② Incorrect use, e.g. overloading of the appliance, use of non-approved accessories
 - ③ Failures and damages caused by product crashes after purchase. The use of force or damage caused by external influences
 - ④ Failures and damages caused by fires, earthquakes or other natural disasters
 - ⑤ Damage caused by non-compliance with the user manual, e.g. Connection to an inadequate power supply or non-compliance with the installation instructions

- ⑥ Failures and damages during the handling and transportation process after purchase
- ⑦ Partially or completely dismantled appliances
- ⑧ Not being able to show the purchase receipt
- ⑨ The warranty card has not been filled with the date of purchase, the customer's name, the name of the retail shop or any of the above data has been modified

5 The warranty card is only valid in THAILAND.
 6 The warranty card must be the original and must be kept appropriately.

Repair memorandum

* The purchase receipt constitutes the certificate corresponding to the repair and replacement conditions clearly stipulated in the user manual. However, the warranty card restricts any customer from enjoying any legal rights from the company (person responsible for the warranty) and any dealer. Please check with retail shop for repair-related matters after the warranty period.
 * Please check the "Warranty and after-sales service" for any repairs after the warranty period and the remaining period of spare parts.

Safety precautions (continued)

- Do not put an object or your hand into the inlet or the outlet**
Failure could cause an injury or property damage.
- Keep the hem of clothing or a necktie away from the inlet**
- Keep accessories such as a necklace away from the inlet**
Failure could cause an injury or property damage.
- Keep your hair away from the inlet**
Failure could cause an injury or property damage.

Caution

The symbol means risks which may lead to a personal injury or property damage if the product is used incorrectly.

- Hold the plug instead of pulling on the power cord when unplugging the product**
Failure could cause damage to the cord, resulting in a fire or an electric shock.
- Do not use the product for any purpose except for shredding**
Failure could cause abnormal operation or a fire.
- Do not operate the product while it is covered or enclosed with a cloth, paper, or a plastic bag**
- Do not use the product at a place full of dust or fine particles**
Failure could cause overheating resulting in a fire.
- Be sure to unplug the product if not in use for a long time**
Failure could cause a fire or an electric shock.

Usage precautions

- Although the battery and charging adapter may become warm during charging, it is not abnormal**
- Use the product to shred the specified number of sheets and within the specified time**
The specified shredding time of this product is three minutes. Do not use the product continuously for more than this specified time. Stop using the product for more than one hour after continuous use.

- Do not put the following objects into the product:**
 - Films, OHP sheets, plastic bags, plastic objects, etc.
 - Carbon paper, thermal paper, wet paper, stickers, adhesive paper, adhesive tape, newspaper, etc.
 - CD, DVD and other discs, plastic cards
 Failure could cause a malfunction of the shredder.
- Be sure to remove clips, pins, and staples from the papers before inserting any papers**
- Do not fill the waste box with shredded paper scraps**
Failure could cause reduced performance or a malfunction of the product.
- Do not conduct the following matters:**
 - Use the shredded paper box or a bin that is not installed with this product.
 - Perform reverse rotation more than needed.
 Failure could cause a failure or a malfunction of the product or scattering of strips of shredded paper.

- Install the product at a place which is not exposed to direct sunlight or hot airflow from an air conditioner or heater unit**
Failure could cause deformation, discoloration, or a malfunction.
- Keep the product away from a radio or a television**
Failure could cause interference to radio or television signal reception
- Do not use the product in a place which has plenty of moisture, oil or smoke, such as in a kitchen**
If the product is used in such a place for a long time, dust may adhere to the inside of the product, which cannot be removed completely.

Disposal
Dispose of the shredder or packaging according to the regulations of your municipal government.

Parts

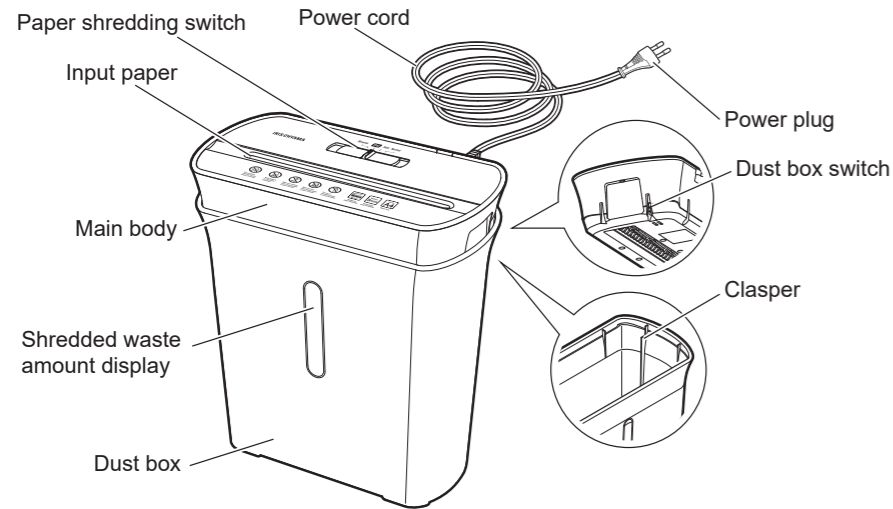

Shredding switch

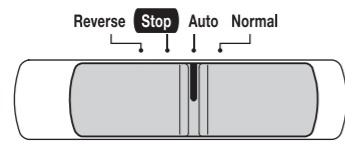

Reverse	Stop	Auto	Normal
The cutter rotates in reverse regardless of whether paper is inserted or not. Use this function if paper has jammed.	Shift the switch to this position after shredding has finished. Be sure to move the switch to this position when relocating the shredder or disposing of shredded paper scraps.	Shredding starts automatically when a sheet of paper is inserted. The product stops when the shredding has finished.	The cutter continues to rotate regardless of whether paper is inserted or not. This function can also be used if paper has jammed.

6

Operation instructions

1 Plug in the product into the socket

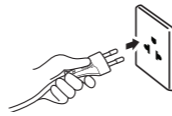

2 Select Auto on the shredding switch

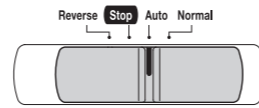

3 Put a straightened paper downwards into the middle of the inlet

- When inserted the paper, it will start shredding automatically.

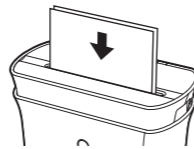

- Put a straightened paper into the inlet. Failure could cause a paper jam.

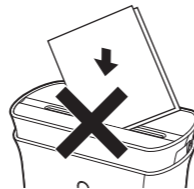

7

The maximum number of sheets that can be shredded at once (maximum number of sheets of paper to be shredded);

A4 copy paper (64g/m²) not more than 8 sheets

The number of sheets that can be shredded continuously;

A4 copy paper (64g/m²) not more than 5 sheets

- The paper shredding performance may according to the paper quality and humidity.
- Do not insert papers continuously. Insert a paper after the previous paper is completely shredded.
- Note that shredding does not start unless the paper passes through the sensor located at the middle of the inlet.
- Do not use the product continuously for more than three minutes.
- Be sure to stop using the product about one hour after continuous use.

- Although the product becomes warm while shredding, it is not a malfunction
- The cutter stops rotating automatically when shredding has finished.

4 Select Stop on the shredding switch and remove the plug from the socket after finishing using the product

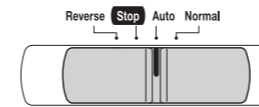

If the shredding suddenly stops

If a large quantity of paper sheets is inserted at once, or a sheet of paper is inserted diagonally, it may cause jamming, which causes the shredder to stop. In this case, remove the paper in accordance with the following procedure:

1 Select Stop on the shredding switch immediately

2 Select Reverse on the shredding switch and remove the jammed paper

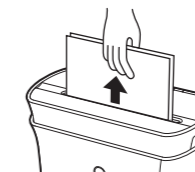
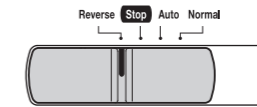

- If the paper cannot be removed easily, pull it out gradually by shaking it to the left and the right, instead of pulling it out forcibly.
- If the cutter stops rotating, repeat normal and reverse rotation by selecting Normal and Reverse on the shredding switch.

- Do not leave the product if shredding has not finished. Non-compliance may cause a failure of the product.
- Do not rotate the cutter in reverse while the waste box is full. Non-compliance may cause a paper jam as shredded paper in the waste box may get caught in the product.

If shredded waste have accumulated

The amount of scrap can be checked through the inspection window of the waste box. Dispose of shredded paper scraps before the box is full.

1 Select Stop on the shredding switch and unplug the product from the socket

2 Remove the body from the waste box and dispose of the shredded paper in the waste box

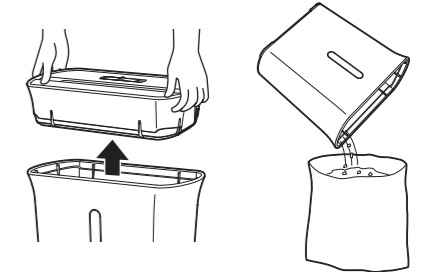

- Dispose of the shredded paper carefully so that it will not scatter.

3 Place the body upright on the waste box and install it at a stable place.

- If the body is not placed on the waste box, the product cannot be run because the waste box switch is not turned on.

- Do not put a plastic bag etc. into a base of the waste box. Failure could cause a malfunction of the waste box switch.

8

Safety system

Overheating prevention system

In the case that the product stops running before shredding has finished and it cannot be restarted by selecting Normal or Reverse with the shredding switch.



Overheating prevention switch is enabled

Shredding stops if the product overheats due to an overload applied to the motor caused by the continuation of shredding beyond the rated time.

If the overheating prevention system is enabled, select Stop on the shredding switch and leave the product for about one hour until the motor system cools down before using it again.

Dust box switch

In the case that the cutter cannot run



The waste box switch is not turned on

It is designed that the product cannot function when the waste box is removed or the body is not placed on the waste box correctly.

Select Stop on the shredding switch and place the body on the waste box correctly.

- If you place the body on the waste box while Normal or Reverse is selected on the shredding switch, the cutter may suddenly start rotating, resulting in an injury, etc.

9

Maintenance



- Be sure to select Stop on the shredding switch and unplug the product.

- Do not use strong alkaline detergent, thinner, benzene, bleach, etc. to clean the body.

Main body and dust box

- Wring out a soft cloth after soaking in water and wipe the body and waste box with it.
- If it is difficult to remove a stain, wipe the stain with a cloth soaked with diluted neutral detergent and then wipe the remaining detergent off with a wrung out dry cloth.

Cutter

In the case that an easy-to-clean shredder sheet (optional) is used

- Shred the Iris Ohyama's easy-to-clean shredder sheet. When the paper is shredded, lubricant spreads over the product, causing the shredding performance to become smooth.

In the case that a copy paper is used

- Put one or two copy papers on a paper and spread machine oil on over the top layer.
- Put another copy paper on a copy paper over which machine oil is spread.
- Shred these papers.

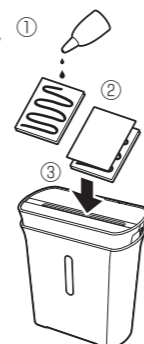

Storage

In the case that the shredder is not used for a long time, store it in a place which is not exposed to direct sunlight and is less humid, and cover the shredder with a plastic bag, etc..

Troubleshooting

Please confirm the following problems after reading the instruction manual carefully before you entrust to repair it.

State	Causes	Measures
The shredder does not shred	The shredder is not plugged into the socket thoroughly	Plug the shredder into the socket thoroughly
	The body is not placed on the waste box properly	Place the body on the waste box correctly
	The overheating protection system is enabled due to operation beyond the specified time	Select Stop on the shredding switch and leave the shredder for one hour until it cools down before using it again
The shredder does not shred even after selecting Auto on the shredding switch and inserting a sheet of paper.	A metal object such as a clip or some foreign matter is caught in the cutter	Remove any object clogging the shredder
	The inserted sheet of paper has not passed the detection sensor	Insert a straightened sheet of paper in such a manner that it passes through the middle of the insertion port
The overheating protection system is enabled frequently.	A semi-transparent sheet of paper (tracing paper) is inserted	Fold a semi-transparent paper before inserting it or insert a semi-transparent paper together with a non-transparent paper overlapping it.
	The cutter is dirty	Conduct maintenance of the cutter by referring to the "Maintenance" section in this manual.

If you cannot resolve the problem after implementing the above actions; Contact the store where the product was purchased from or the Iris Call Center.



- Do not disassemble, repair or modify the shredder by yourself.

10

Specifications

Power supply voltage	220V~ 50Hz
Power consumption	165W
Insertion port width	220mm
Size of shredded paper	5×37mm
Shredding speed	3.7m/minutes
Maximum number of paper sheets that can be shredded	A4 copy sheet (wood-free paper 64g/m ²) 8 sheets
Specified number of paper sheets to be shredded	A4 copy sheet (wood-free paper 64g/m ²) 5 sheets
Specified time	3 minutes (continuous operating time)
Capacity of the waste box	8.9L
Safety device	Thermal protector, waste box switch, thermal fuse
Outside dimensions	W321 x D169 x H350mm
Weight	3.7kg
Length of the power cord	Approx. 1.4m

* The above product specification is subject to change without advanced notice.

Warranty and after-sales services

Please make sure to carefully read the following contents.

Purchase Receipt

Be sure to request a Purchase Receipt at the retail shop when purchase the product. The repair fee needs to be paid if you are unable to present a Purchase Receipt. Therefore, you must keep the Purchase Receipt securely.

Within the warranty period

Warranty period: Time limit specified by the warranty card (Back cover). The company will provide free repair as per the "Warranty Provisions" under abnormal operating conditions within the warranty period.

Over the warranty period

Please check with retail shop and you will have to pay for related repair expenses. It will be possible to maintain the functions of the product after repair. A certain repair cost will be charged according to customer's requirements.

About the remaining period of spares parts

The remaining period of the company's major spare parts is 5 years after stopped production of this product. The spare parts in operation correspond to the spare needed to maintain the functions of parts needed to maintain the functions of the product.

About after-sales service

Please check with retail shop for other after-sales issues.

11