

- CODE:805505 ㊦タイ取説自動給水機PWF
- サイズ:W148×H210mm (A5)
- 材 質:上質紙 70kg
- 刷 色:1C/1C (BLACK)

EN

PWF-200



EN

Pet Water Fountain

PWF-200

Instructions manual

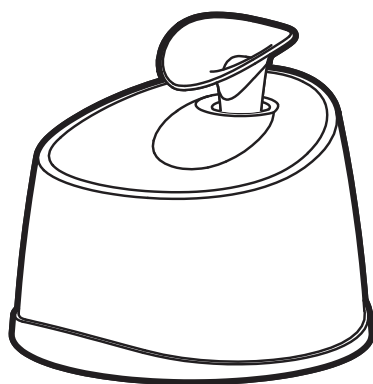

Content

Preparations before use

Safety precautions.....	2
Parts.....	4

Operation instructions

How to use.....	4
Cleaning and maintenance.....	6

Others

Specifications	7
Warranty and after-sales services.....	7
Warranty card.....	Back cover

Safety precautions

Make sure to carefully read the following "Safety Precautions" before use in order to operate the product properly. The Operation Manual records the matters must observe, to avoid personal injury or unnecessary property loss to anybody.

Meanings of symbols



Indicates reminder and warning.



Indicates DO NOT.



Indicates ALWAYS DO.



Warning

The symbol means matters which may lead to death or serious injury during faulty operation.

- **Please utilize a socket of 220V~ .**
Or it may lead to fire, electric shock.
- **Wipe clean the dust attached on the male tab of the power plug and the installation surface of the male table with a dry cloth.**
Or it may lead to fire or insulation fault due to humidity.
- **Make sure to insert the power plug firmly.**
Or it may lead to fire, short circuit or electric shock.
- **Make sure to pull out the power plug from the socket before cleaning, maintaining, checking and moving the product.**
- **Operate the product on the horizontal and steady hard floor.**
Do not operate the product on a unsteady place; or it may lead to abnormal operation, turnover or contamination of surrounding environment.
- **Pets may spill water.**
Please use it on a flat place.
- **Make sure hold the power plug with hands when pulling out the power plug, and do not drag the power line.**
Or it may lead to fire or electric shock due to power line damage.
- **Please use when the water pump is totally immersed into water.**
- **Make sure to confirm if there is damage on the power line before use each time.**
Pets may bite the power line.
Please make sure there is no scratching or exposure of the power line before use.



- **The appliance is only to be used with the power supply unit provided with the appliance. The cord cannot be replaced. If the cord is damaged the appliance should be scrapped.**
- **This appliance can be used by children aged from 8 years and above and persons with reduced physical, sensory or mental capabilities or lack of experience and knowledge if they have been given supervision or instruction concerning use of the appliance in a safe way and understand the hazards involved. Children shall not play with the appliance. Cleaning and user maintenance shall not be made by children without supervision.**



- **Do not insert or pull out the power plug with wet hands.**
Or it may lead to electric shock, scald or injury.
- **Do not use a damaged power line or power plug and loose socket.**
Or it may lead to fire, short circuit or electric shock.
- **Do not damage, bend with strength, drag, twist or bind the power line or energize.**
- **Do not get close to the high-temperature position of the power line, or place a heavy load on the power line or squeeze it.**
Or it may lead to fire disaster or electric shock due to power line damage.
- **Do not adsorb flammable substances such as lamp oil, gasoline and soda water, or combustion source or toner, or operate the product around them.**
Or it may lead to fire
- **Do not operate the product in an outdoor environment.**
- **Do not disassemble, repair or transform parts without authorization.**
Or it may lead to fire, electric shock or injury.
- **Keep away from fire.**
Or it may lead to short circuit or fire due to deformation on the main body or the power line.

Parts

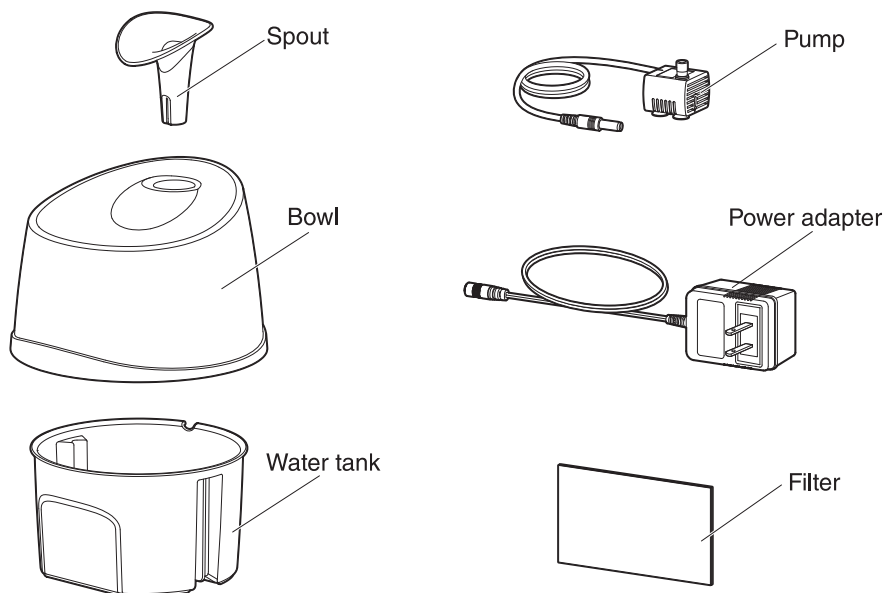

How to use

Please wash all components carefully before use.

***Be sure that the filter had rinsed before use.**

1 Please install the strainer on the main body.

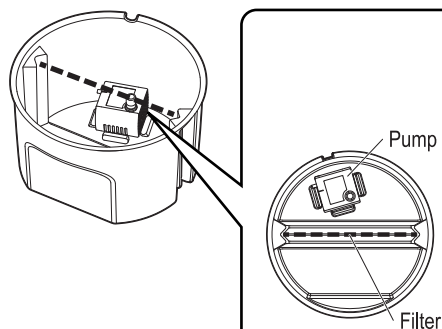

- Please pay attention to the direction of the pump.
- Please install the filter on the groove of the water tank.
- Attach the pump to the water tank using the suction cups. Ensure the flow tube on the underside the bowl is seated completely over the pump outlet.

How to use Continued

2 Please pour water into the main body.

- Please keep the water between the two water lines.
- Please only turn the power on when the water is at the max water line.
- It is recommended to replace the water every day.

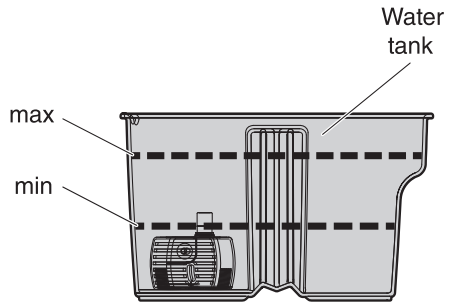

3 Install the Bowl.

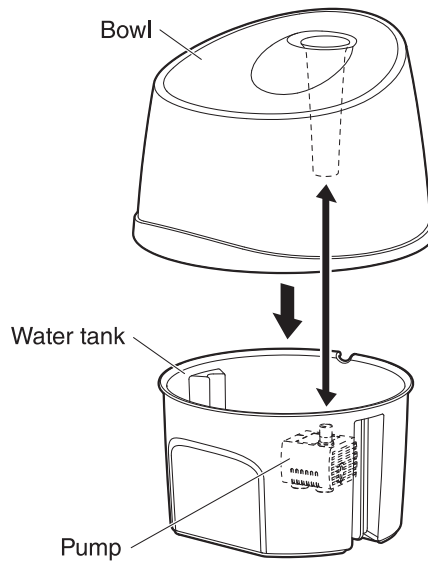

How to use

Continued

4 Connect between the pump and power adapter.

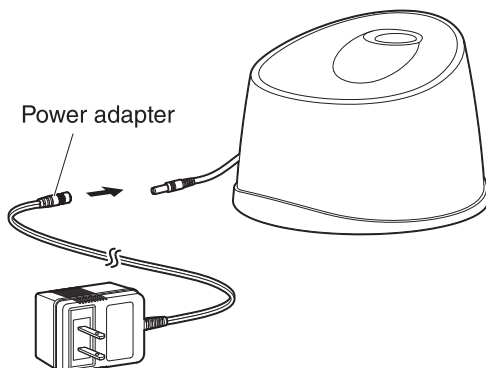

5 Please install spout if necessary.

The spout determine the direction of water.

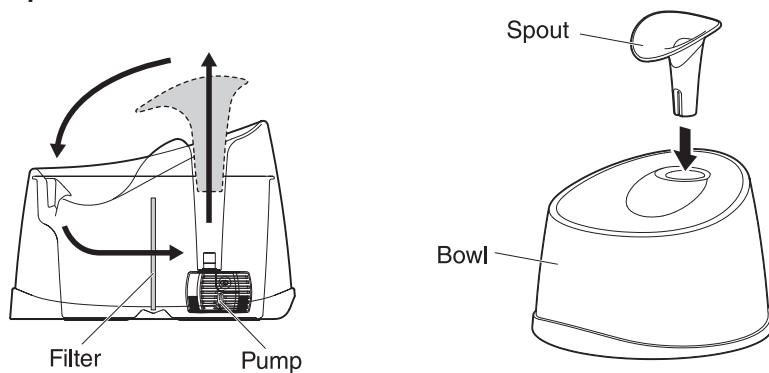

Cleaning and maintenance

Please observe the following matters for long term use.

- Please wash the pump about every 2 weeks

1. Disassemble the bowl of the pump.
2. Remove the bonnet cap.
3. Absorb the kitchen special purpose detergent diluted with warm water, to clean the components.

- Please replace with a new filter every 2-4 weeks.

The interval for replacement is determined by the number of your pets and daily using time.

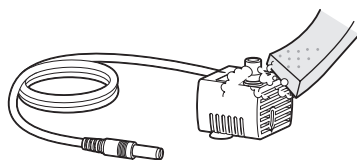

Specifications

Adapter	Input	220V~ 50Hz
	Output	12V~ 250mA
Rated power		4W
Application		Pet water dispenser
Product size (approx.)	unit	W205XD205XH141 mm
	unit and attachments	W205XD205XH175 mm
Product weight (approx.)		0.6kg

※ The specifications may be changed with no additional notification.

Warranty and after-sales services

Please make sure to carefully read the following contents.

■ Purchase Receipt

Be sure to request a Purchase Receipt at the retail shop when purchase the product.

The repair fee needs to be paid if you are unable to present a Purchase Receipt. Therefore, you must keep the Purchase Receipt securely.

■ Within the warranty period

Warranty period: Time limit specified by the warranty card (Back cover).

The company will provide free repair as per the "Warranty Provisions" under abnormal operating conditions within the warranty period.

■ Over the warranty period

Please check with retail shop and you will have to pay for related repair expenses. It will be possible to maintain the functions of the product after repair. A certain repair cost will be charged according to customer's requirements.

■ About the remaining period of spares parts

The remaining period of the company's major spare parts is 5 years after stopped production of this product. The spare parts in operation correspond to the spare needed to maintain the functions of parts needed to maintain the functions of the product.

■ About after-sales service

Please check with retail shop for other after-sales issues.