

■品名：OS_356909_RNS-P10-SG
■サイズ：420×H297mm(A3)
■材 質：上質紙 菊判48.5kg (81.4g/m²)
■刷 色：1C/1C(BLACK)



Rinser Cleaner

Indoor/Household Use Only

RNS-P10

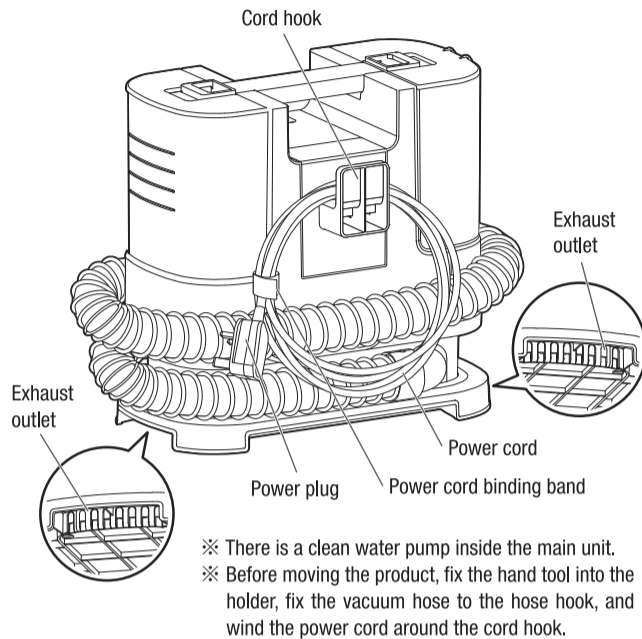
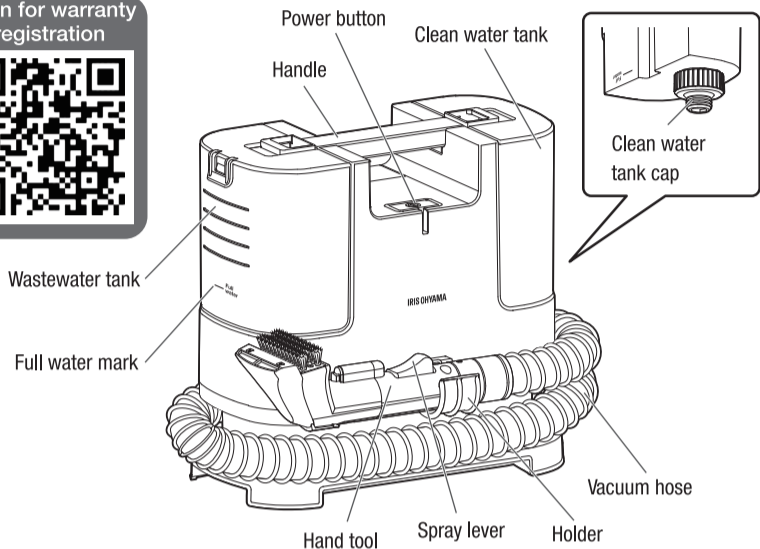

※ There is a clean water pump inside the main unit.
※ Before moving the product, fix the hand tool into the holder, fix the vacuum hose to the hose hook, and wind the power cord around the cord hook.

Accessories

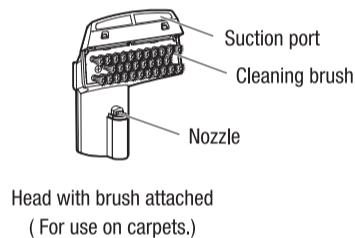

Head with brush attached
(For use on carpets.)

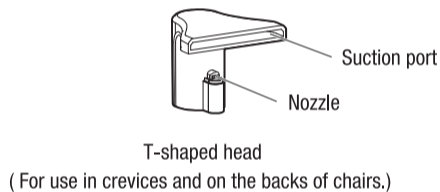

T-shaped head
(For use in crevices and on the backs of chairs.)

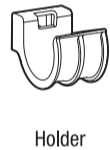

Holder

Preparation

1. Remove the clean water tank from the main unit

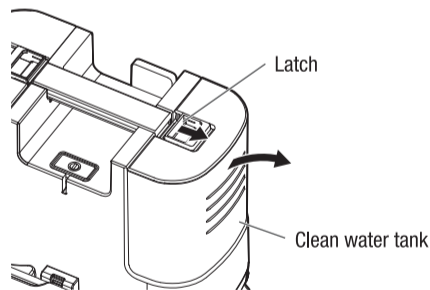

3. Attach the clean water tank so that it is aligned with the slide on the main unit

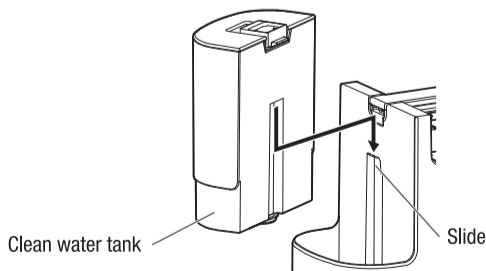

Caution

- Do not tilt the clean water tank when moving it. Doing so could cause water to spill out.

2. Fill the clean water tank with tap water up to the full water mark and screw on the cap

- Capacity is about 1 liter.

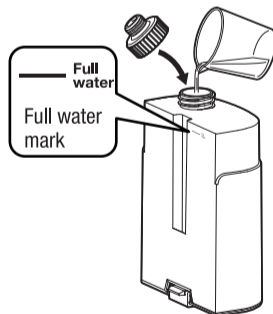

Caution

- Make sure that the cap for the clean water tank is screwed on tightly.
- Only use tap water or alkaline ionized water in the clean water tank. The use of any other kind of water or liquids may increase the risk of malfunction.
- Empty out any water remaining in the clean water tank after use. If water is left in the tank, it could increase the risk of leakage or mold growth.

4. Connect the head

- The head into the hand tool.

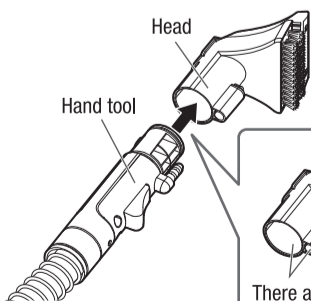

Press the head in so that these 2 holes fit.

Quick Operation Guide

Important safety information on reverse side

To avoid causing harm and property damage to you or others, please carefully read and follow the "Safety Precautions" below.

How to use

1. Insert the power plug

- Insert the power plug into the socket.

2. Turn on the power (product starts)

- Press the power button to turn on the product.

3. Squeeze the spray lever to apply clean water to an area

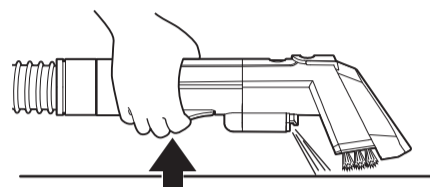

- Apply clean water to dirty areas to wash away the dirt.
- Water might keep dripping for a few seconds after the spray lever is released.
- Do not spray water onto the same area continuously. Vacuum the water immediately after spraying. If water soaks deep into cloth, it will remain and cause mold or bad smells.

4. Vacuum any remaining water

(Spray and vacuum water simultaneously)

- Pull the hand tool towards yourself slowly and vacuum up water and dirt while keeping the suction port pressed gently to the area being cleaned.

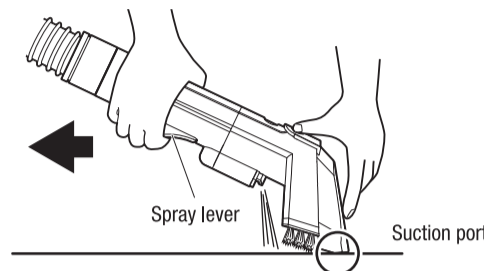

5. Turn off the power (product stops)

- Press the power button again to turn off the product.

6. Unplug the power plug

- Unplug the power plug from the electrical outlet after using the product.

How to use the Head and T-shaped head

Clean dirt which is hard to clean or has stained after releasing the dirt with a detergent.

Head with brush attached

- Please use it for carpet.

T-shaped head

- Please use this for space, seat, car seat, ceiling, etc.

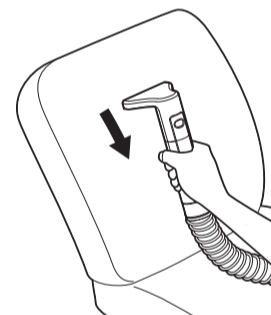
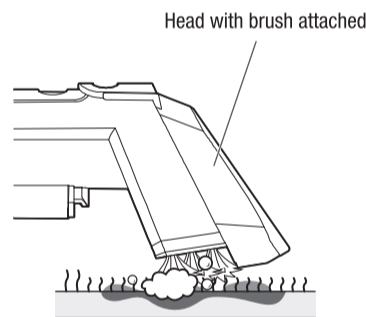

Recommended for use

- Strong alkaline ionized water
 - Baking soda
 - Citric acid
 - Hypochlorous acid
- Such as detergent producing less foam.

Not appropriate

- Neutral detergent for kitchen use
 - Strongly alkaline detergent
 - Strongly acidic detergent
- When using a detergent with a lot of foam, the foam might get inside the cleaner.

Cleaning and maintenance



Caution

- Make sure the unit is powered off and unplugged before conducting any maintenance.
- Take care not to get any liquid into the body of the product. If liquid gets inside the body, it may increase the risk of malfunction, electrocution, or injury.
- Do not use detergent, thinner, benzene, bleach, etc.

1. Empty out any water remaining in the clean water tank and wastewater tank

2. Press the power button to turn on the power

3. Squeeze the spray lever so that the air pushes out and removes any water remaining inside the main unit (the clean water pump)

- If water stops coming out, turn off the power by pressing the power button, and unplug the power plug from the outlet.
- Do not store in a location where the temperature is below freezing.
- Store in a dry place away from direct sunlight.

Attach the cover to the wastewater tank

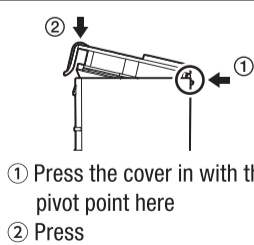

- Press the cover in with the pivot point here
- Press



確認用

Cleaning and maintenance continued

Head / wastewater tank / clean water tank (After every use)

- Remove these accessories from the main unit, clean with water, and dry thoroughly.
- If something is stuck in the nozzle, remove it by cleaning the nozzle.
- If it is difficult to remove dirt, please wipe with a soft cloth dipped in diluted kitchen cleaner.

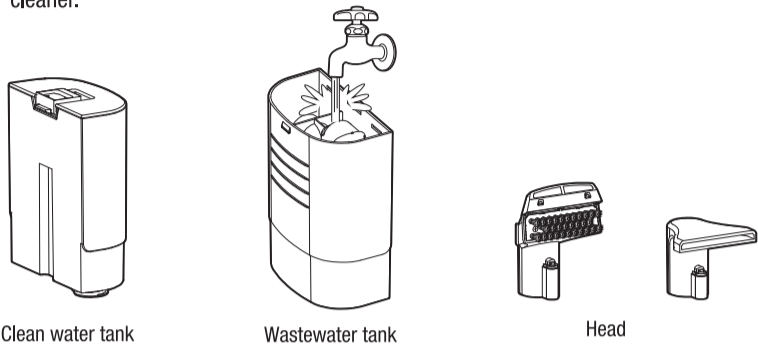

Vacuum filter / clean water filter

- If something is stuck in the vacuum filter, clean it or replace it with a new one.
- If cleaning the vacuum filter with water, put it in a breezy and shady place to dry before refitting.
- Be sure to install the vacuum filter after doing cleaning and maintenance.

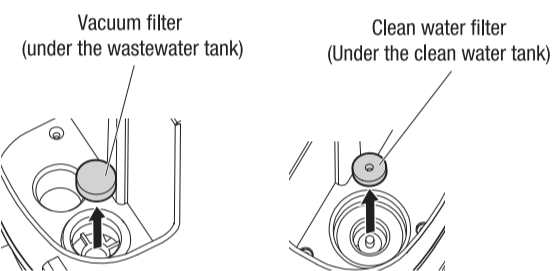

※ Use tweezers to get at the clean water filter more easily.

Main unit (When dirty)

- Wring out a soft cloth that has been soaked in hot water (no hotter than 40°C) and wipe off any dirt.
- If the dirt cannot be easily wiped off, wipe with a soft cloth that has been soaked in a diluted kitchen detergent. Then, use a tightly wrung out cloth to wipe away any remaining water or detergent.

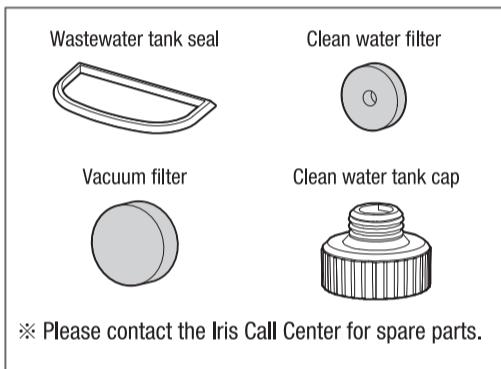
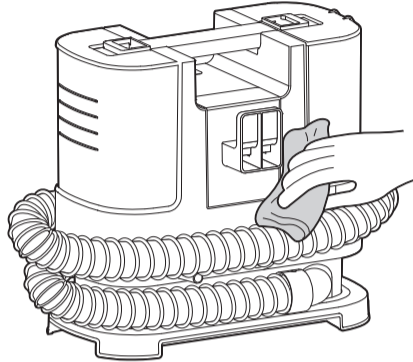

※ Please contact the Iris Call Center for spare parts.

Safety Precautions

Make sure to read the “Safety Precautions” first in order to use the cleaner correctly. The safety precautions describe the matters to observe in order to prevent any personal injury or property damage.

Examples of symbols.



This symbol means “Reminder”.



This symbol means “Prohibited”.



This symbol means “Recommended”.



Danger

The symbol means risk likely to lead to death or serious injury if the product is used incorrectly.



- Flush eyes immediately if any electrolyte solution gets into them
Failure may cause damage eyes. Seek medical attention immediately after flushing the eyes.



- Do not disassemble the battery
Failure may cause overheating or an explosion resulting in a fire or injury.



- Do not charge the battery in any way except as specified.
- Do not charge the battery of this product in a hot place or a place exposed to direct sunlight.
- Do not drop the product or subject it to any strong shock.
- Do not wet the battery.
The battery is installed incorrectly. Failure could cause fire or injury due to heat, explosion, leakage.



Warning

The symbol means matters that may lead to death or serious injury during faulty operation.



- In the case that any abnormality or failure occurs with the product, stop using the product immediately and unplug the charging adapter
Failure may cause smoke, fire, or an electric shock.

[Examples of abnormalities]

- Abnormal sound or smell
- The charging adapter overheats abnormally
→ Stop using the product and contact the store where the product was purchased or the Iris Call Center.



- Do not disassemble, repair, or modify the product
Failure may cause a fire, an electric shock, or injury.
For any repair, contact the store where the product was purchased or the Iris Call Center.



- If the supply cord is damaged, it must be replaced by the manufacturer, its service agent or similarly qualified persons in order to avoid a hazard



- Do not spray or immerse the product with insecticides, hair dressings, lubricating oil, etc
- Keep combustible substances (e.g., kerosene, gasoline, thinner, copy tonner) or ammalbe substances away from the product, and do not immerse the product into these substances
- Be sure to install the recovery tank when using the product
Failure may cause an injury.



- This appliance is not intended for use by persons (including children) with reduced physical, sensory or mental capabilities, or lack of experience and knowledge, unless they have been given supervision or instruction concerning use of the appliance by a person responsible for their safety

- Children should be supervised to ensure that they do not play with the appliance

Use the charging adapter correctly



- Insert the charging adapter's plug securely into the power socket
Failure may cause a short circuit, resulting in fire or electric shock.



- Do not insert or remove the charging adapter with a wet hand
Failure may cause an electric shock, burn, or an injury.



- Only use the product with 220-240V~ voltage
Failure may cause a fire or an electric shock.



- Do not use the product in places with the possibility of getting wet, such as outside in the rain, in wet areas, or in a bathroom
- Do not wet the product or the charging adapter, or immerse either unit in water
Failure may cause a fire or an electric shock.



Cautions

The symbol means a risk that may lead to personal injury or property damage if the product is used incorrectly.



- Do not use the product for any purpose except household cleaning
Failure may cause a malfunction or a fire.

- Do not use the product for any purpose except household use (not for a business purpose, etc.)
This product is designed only for household use.

If the product is used for any purpose except household use, including for a business purpose, such use may cause a fire, etc.



- Do not use the product while the suction opening is blocked
- Make sure that the exhaust opening is clear
Failure may cause deformation, malfunction, or a fire due to overheating.



- Keep the product away from fire, heat sources, heaters, etc
The air flowing from the product may increase any flame, which may lead to a fire.



- Do not climb or lean on the product
- Do not use the product in a place within the reach of children.
- Do not allow children to use the product without supervision
- Do not use the product outdoors
Failure may cause a malfunction, resulting in a short circuit or a fire.



- Hold the charging adapter instead of pulling on the power cord to unplug the charging adapter
Failure may damage the cord, resulting in a fire or an electric shock.

- Be sure to remove the charging adapter from the power socket after use
Failure may cause a fire or an electric shock.



- Fully charge the product before long-time storage

Warranty and after-sales services

Be sure to carefully read the following contents.

■ Warranty card

Customers can conveniently register their warranty by scanning the QR code on the first page. If the warranty card cannot be shown within the warranty period.

■ Within the warranty period

Warranty period: one year from the date of purchase.
The company will maintain for free according to Warranty Terms if failure occurs within the warranty period.

■ Beyond the warranty period

Please consult the shop where you purchase. It is necessary to pay the relevant maintenance cost.

■ About the warranty period for components

The warranty period for the important components of the product shall be one year after the company suspends production.

■ About after-sales service

For other after-sales services not mentioned here, please consult the shop where you purchase.

Rinser Cleaner RNS-P10 Warranty card

This warranty card is a certificate for providing free repair according to the following warranty terms in case of failure within the following period from the date of purchase.

Purchase date※		Warranty period	
MM DD YY		1 year since the purchase day Except for consumables	
Customer	Name		
	Address and postal code		
	Tel		() -
Shop	Address and shop name		
	Tel		() -

Instruction to Shop: please fill out items with※before handing over the warranty card to the customer.

Carry-in warranty terms

1. This carry-in warranty starts on the date of purchase and expires in ONE (1) year to cover manufacturing defects caused during a normal use according to the operating manual as well as the precautions stated on the product and packaging.
2. To claim the carry-in warranty service, customers should bring the complete unit and accessories to our service centre in local market during the operational hours together with this warranty card and dated original receipt/invoice.
3. If the product is confirmed to be defective by the distributor's authorized personnel, the company at its own discretion may repair or replace the complete or part of the product at no cost.
4. Carry-in Warranty claim will be invalid and repair cost shall be paid by customer in the following situations.
 - (a) Failure and damage caused by improper use and unauthorized maintenance.
 - (b) Failure and damage caused by careless drop after purchase.
 - (c) Failure and damage caused by fire, earthquake or other natural disasters.
 - (d) Failure and damage caused when the product is used for commercial purposes such as used in an industry for a long time, or in a vehicle or a ship.
 - (e) Failure and damage caused by handling, transportation and other processes.
 - (f) Failure to show the warranty card and dated original receipt/invoice.
 - (g) Date of purchase, customer name, shop name not indicated on the warranty card or altered.
5. The carry-in warranty services are applicable only for products purchased in local market.

Precautions for use

- This product removes dirt by rinsing. Only water (clean tap or alkaline ionized) that is 40°C or cooler should be put into the clean water tank.
- This product cannot be used to rinse works of art, water sensitive fibers (silk, acetate, rayon, cupra, etc.), water sensitive products (fur, leather products, kimono), or vulnerable surfaces (flooring, table, etc.).
- Do not tilt or drop the product when filled with water. Doing so may increase the risk of water spillage.
- If a large amount of foam has accumulated in the wastewater tank and is above the Full-water mark, stop the product immediately and empty the wastewater. Failure to do so could cause the product to malfunction.
- If cleaning with a detergent, a low-foaming variety should be used. Dilute it with water (1 part detergent to 20 parts water) before applying it directly to the rinsing surface.
- When using a detergent, test that there is no adverse effect on the rinsing surface before use.
- The product may stop when used on a thick carpets due to the exhaust port getting clogged with fibers.
- Do not vacuum the following substances.
 - Dry dust
 - Large volumes of powder (extinguishing component of a fire extinguisher, etc.)
 - Large volumes of sand, small stones, etc.
 - Large volumes of waste
 - Sharp metal or glass objects, such as needles or broken bottles
 - Large debris
 - Objects that can easily become tangled or clogged in the product, e. g. plastic bags or stockings

- Do not vacuum dry dust. This product is a wet vacuum. Vacuuming dry debris / dust may increase the risk of malfunction.
- If in a cold region, make sure to empty out any remaining water from the wastewater tank, clean water tank, vacuum hose, and hand tool after use. Store the product in a location where the temperature is above freezing. Water that freezes inside of the product or its parts may cause damage.
- If the hose becomes clogged during operation, button off the power immediately. Unplug the power plug from the socket, disconnect the hose, and clear out anything inside that is causing an obstruction. Failure to do so could cause the product to malfunction.

About the protection mechanism

This product includes a safety mechanism to protect the motor from getting overheated. If the exhaust outlet is blocked or not functioning properly, this safety mechanism will activate, shutting down the product and temporarily preventing it from powering on.

- If the protection mechanism activates:
 - Press the power button to turn off the main unit, and unplug the power cord from the outlet.
 - Place the product in a cool place.

The safety device resets after about one hour, and after that the product should work normally again.

About disposal

- When disposing of the product, do not remove the battery, but dispose of it as a small household electrical product fitted with a lithium-ion battery in compliance with the regulations of the local government in your area.

Brand Principal: IRIS Ohyama Inc.,

Address: 2-12-1, Itsutsubashi, Aoba-ku, Sendai-shi, Miyagi-ken, Japan

Manufacturer: Dalian Iris Ohyama Development Co.,Ltd.

Address: No.6-4, Bai Shi Bay Economic & Technological Development Zone,Dalian, P.R.China

確認用